

L A  B O Y[®]

By

 KOMFLEX

AIR COLLECTION
USER GUIDE



Quick Setup

Parts

Swivel Pole



Part 1

360 Anti Tangle System



Part 2

Power Adapter



Part 3

Aluminium Alloy Base

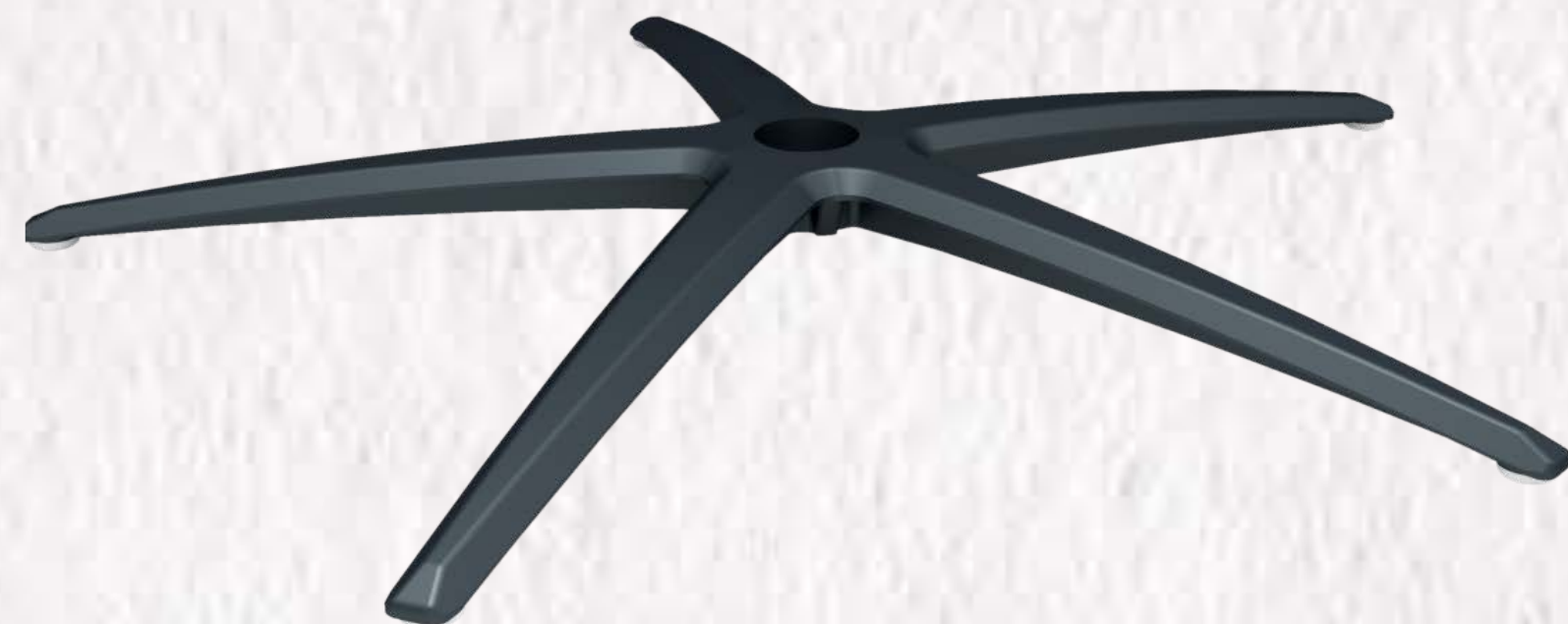

Part 4

Assemble

Step 1



Step 2



Step 3



Step 4



L A Z B O Y

KOMFLEX

AIR COLLECTION

Quick Setup

Assemble

Step 5

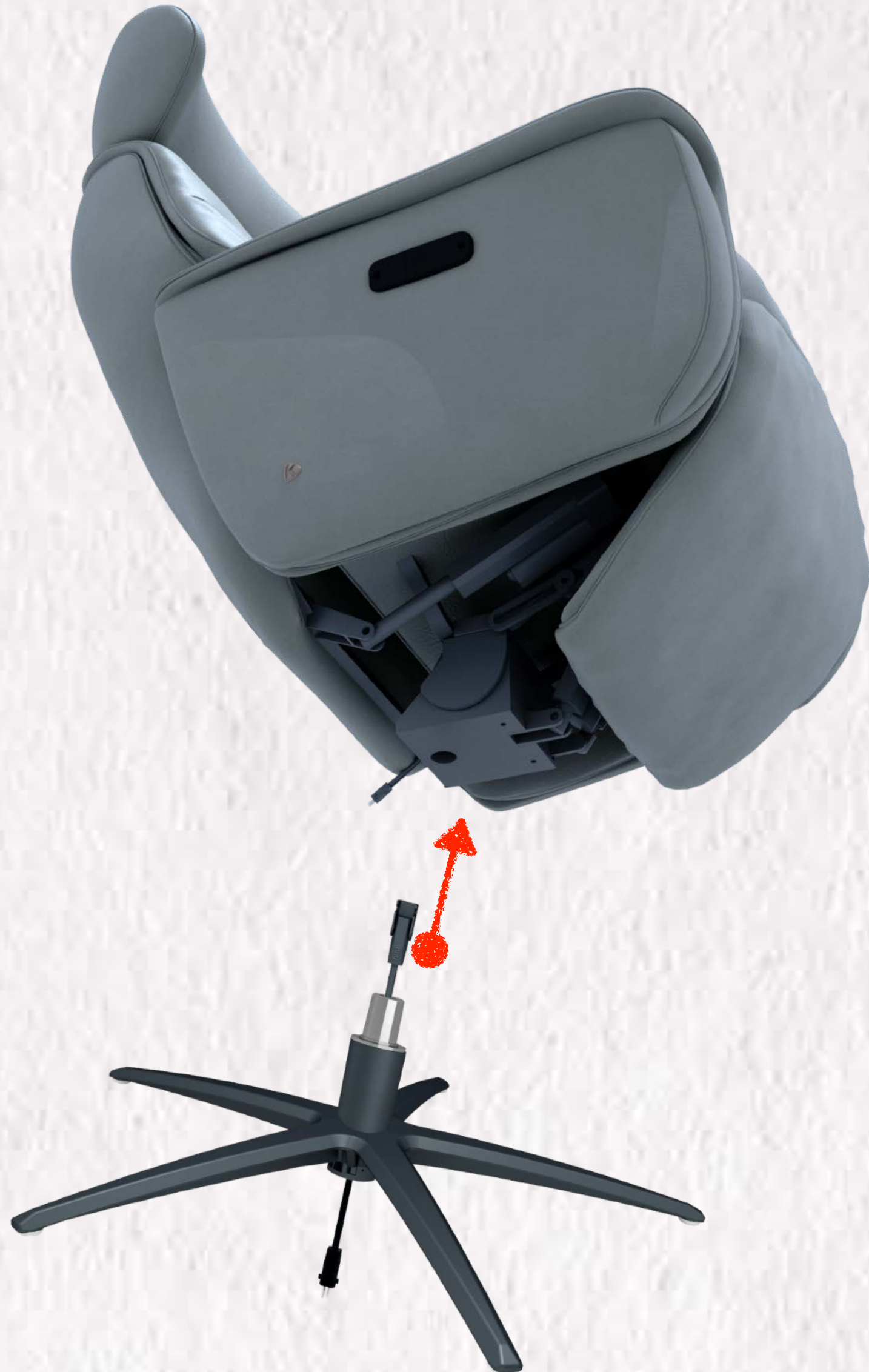

Step 6

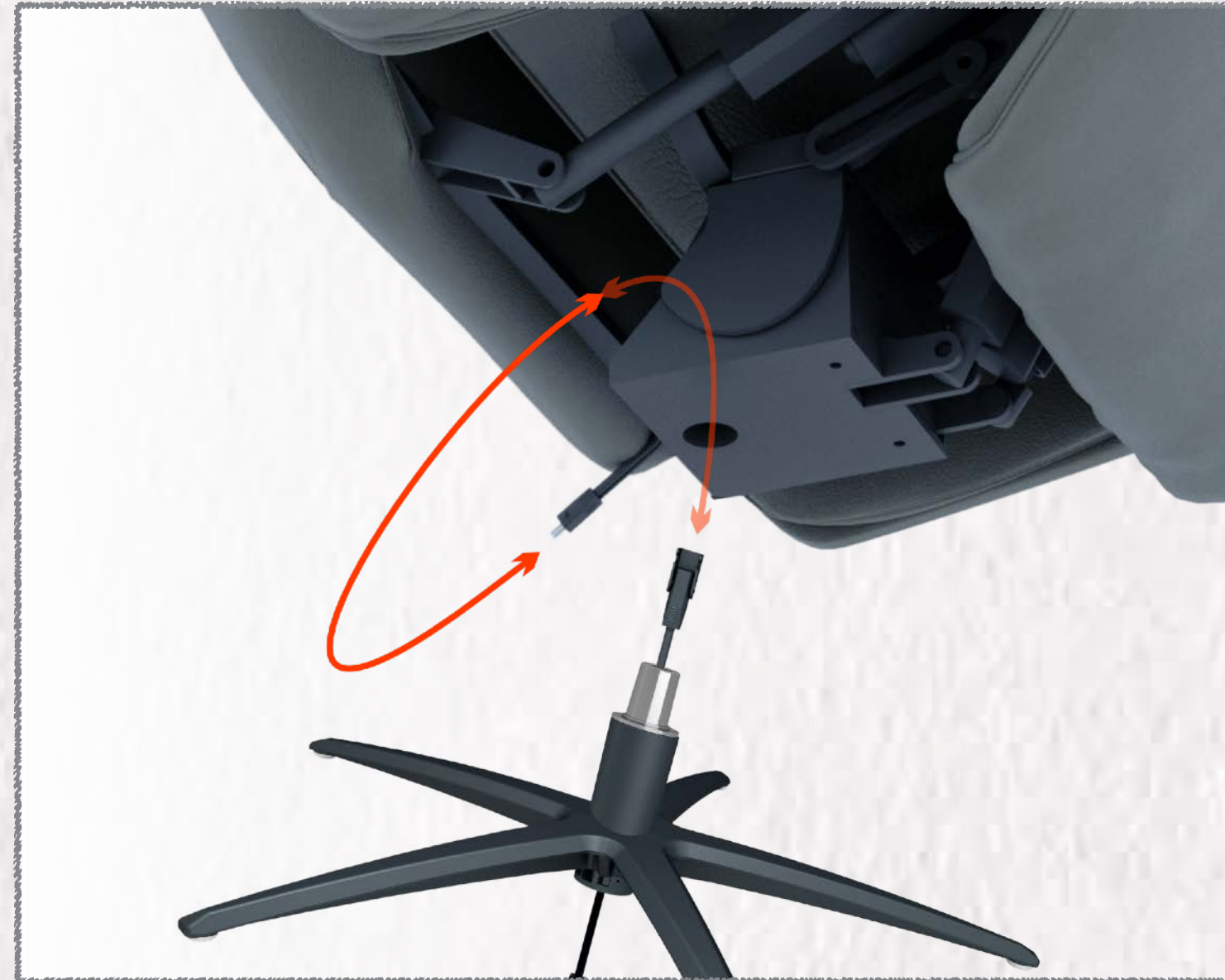

Step 7



Quick Setup

Unlock The System



Handle Controller



Home Button
"Side view"

Press in

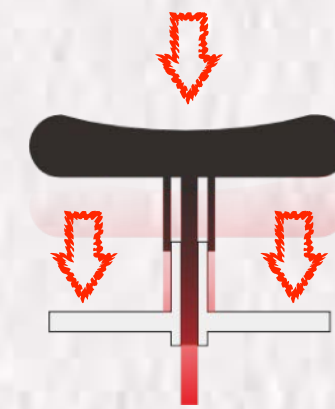

Home Button
"Top view"

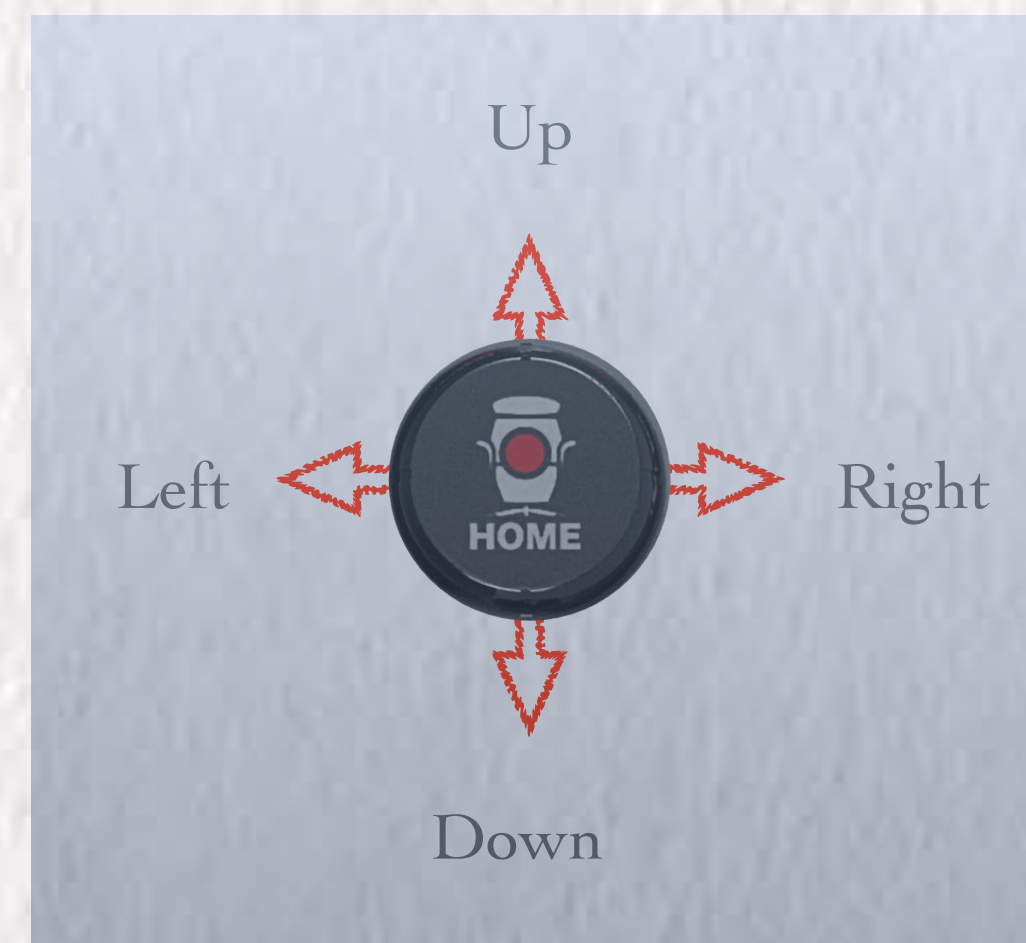

Each time the power connected to the system will turned on, pressing in the Home button will produce a "Beeee" sound, signifying system unlocking and the chair returning to its initial position.

L A Z B O Y

KOMFLEX

AIR COLLECTION

All-In-One Ergonomic chair.

Features Introduction



Adjustable Headrest



Anti-Tangle Power System

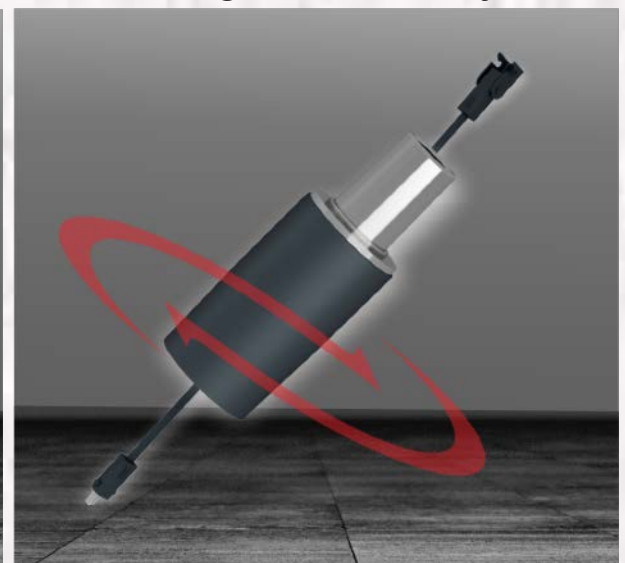

360 Swivel



One Click Home Button

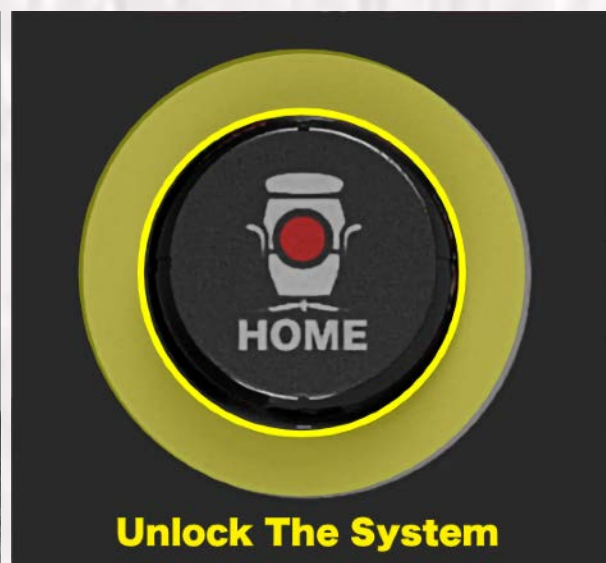

Magnetic Mounting.



User Manual for Hand Controller



 HOME
Home Button

 HOME
Press In

1 Joystick
"Side view"

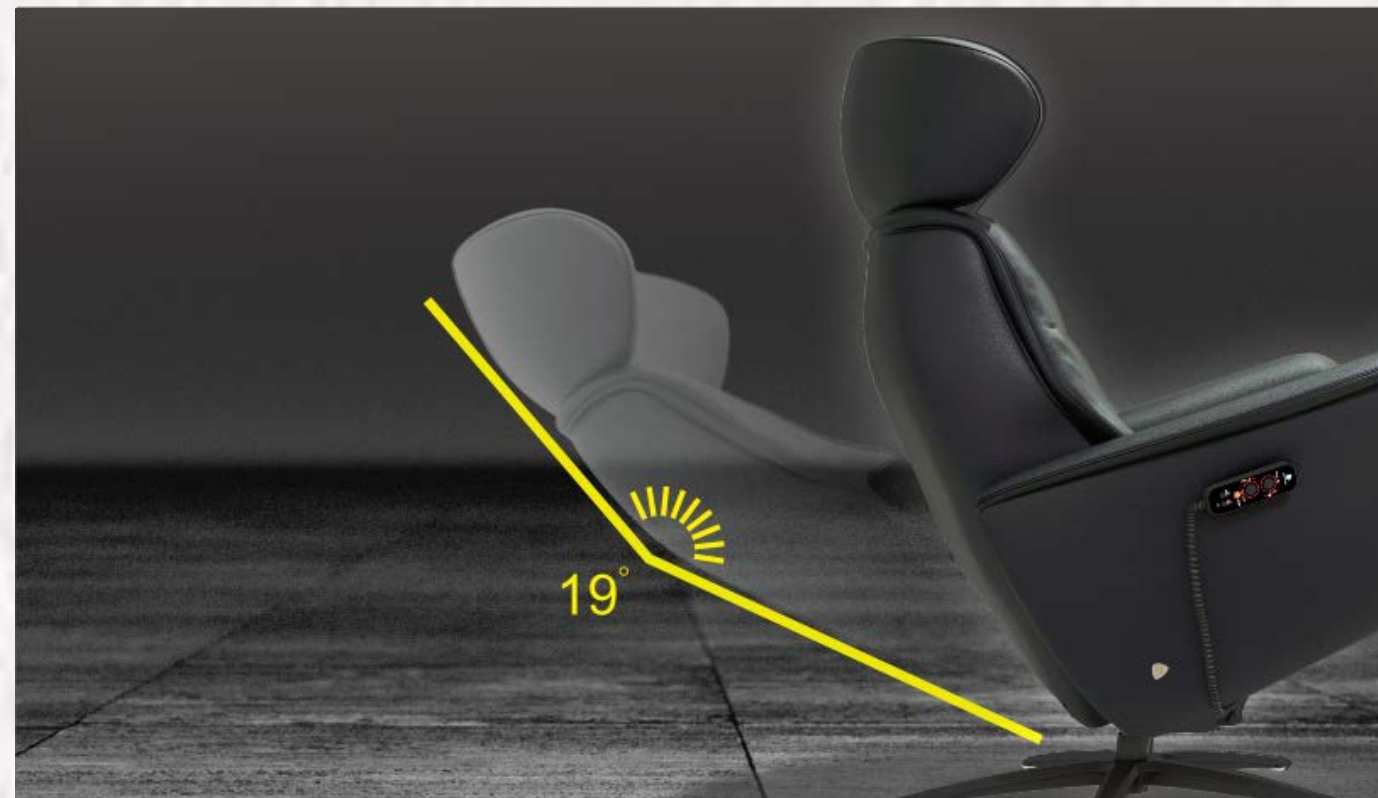

 19°
Dynamic Back Motion

Up

Down

1 Joystick
"Top view"



 Footrest Motion

Left  Right

1 Joystick
"Top view"

"Top view"

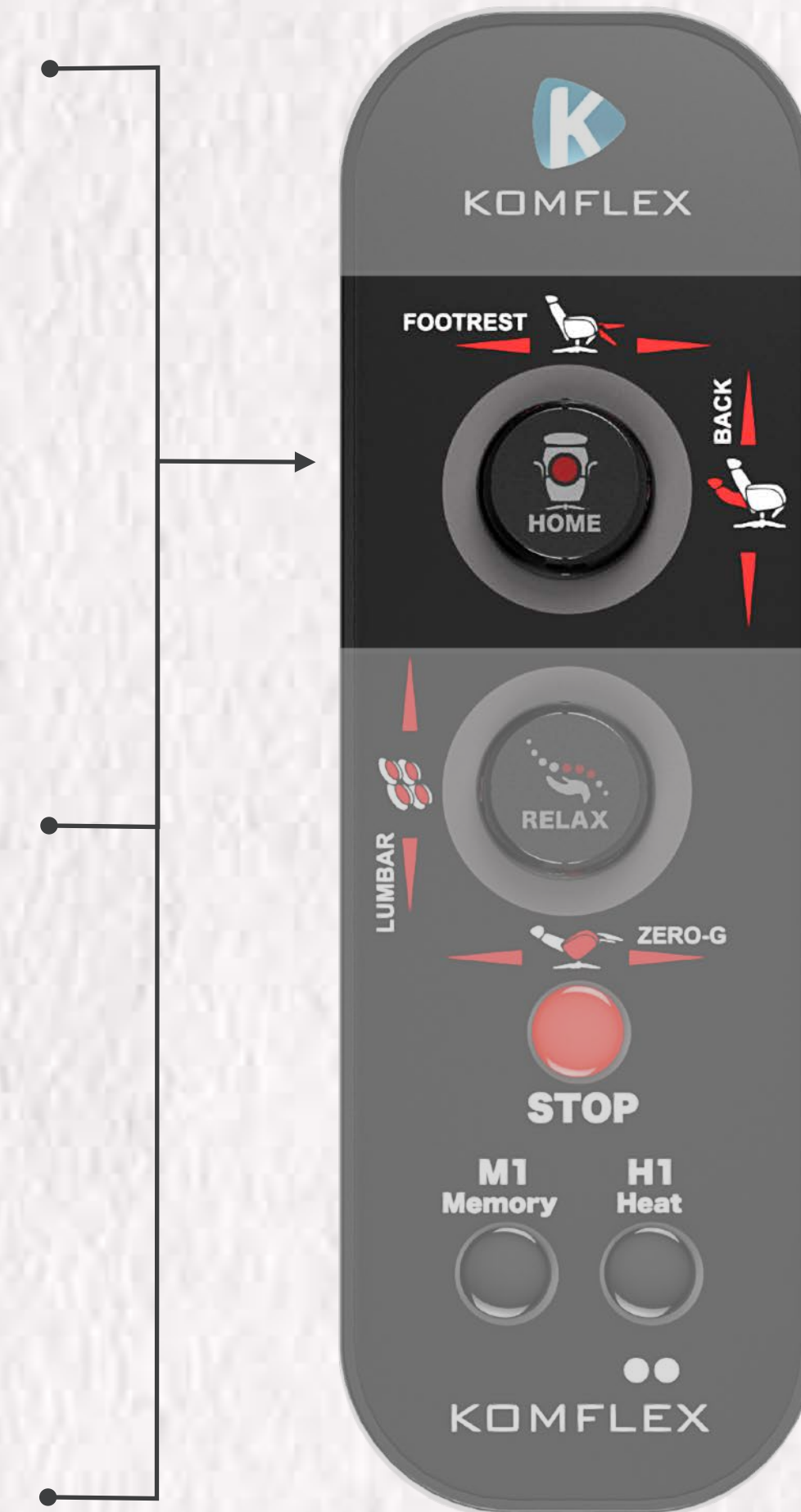

1 Joystick

User Manual for Hand Controller



Relax
Button



Press
In

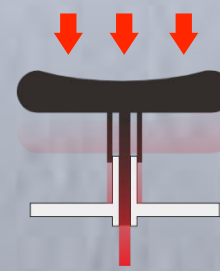

2 Joystick
"Side view"



Lumber
Support

Up



Down

2 Joystick
"Top view"

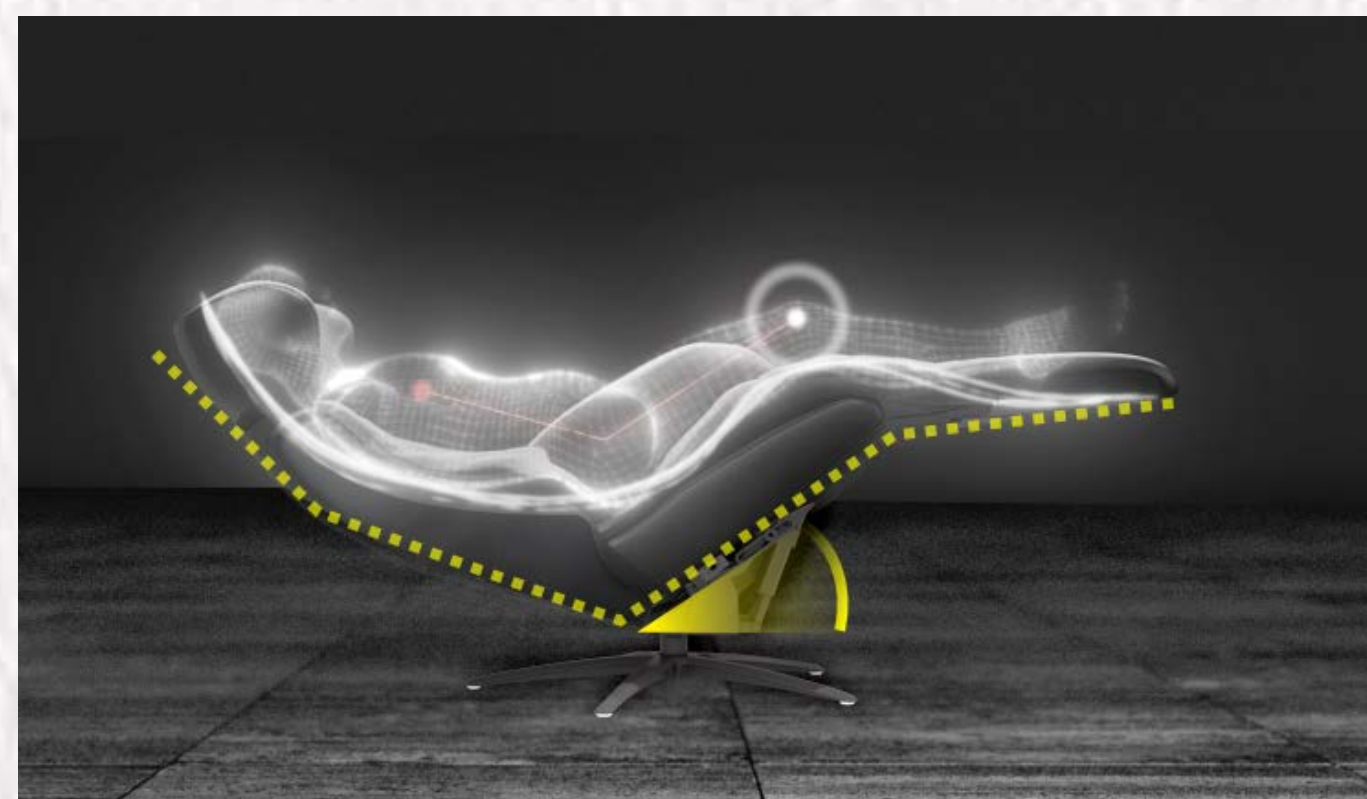

Zero G
Motion

Left Right



2 Joystick
"Top view"

"Top view"

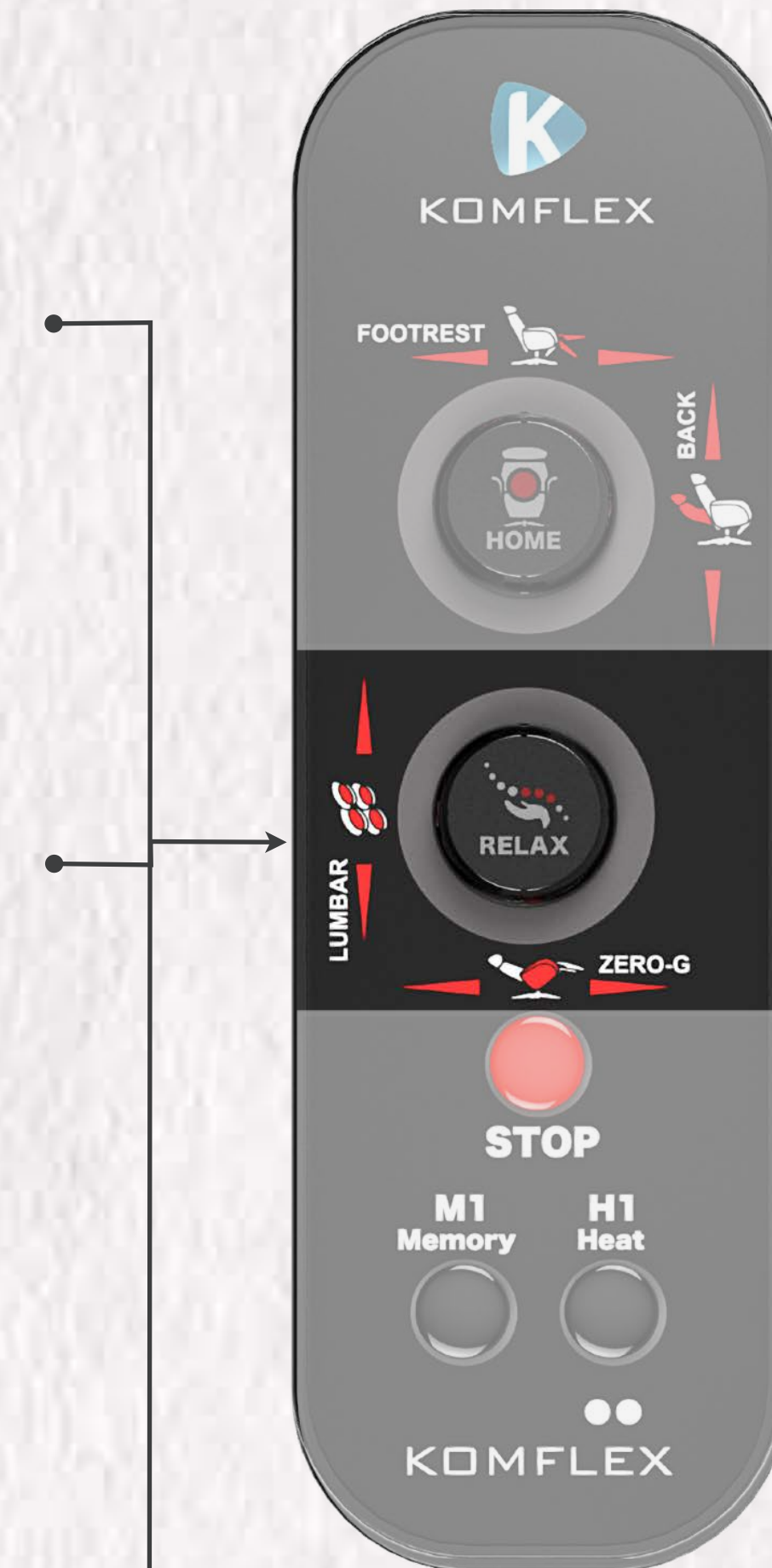

2 Joystick

L A Z B O Y

KOMFLEX

AIR COLLECTION

User Manual for Hand Controller

“Top view”

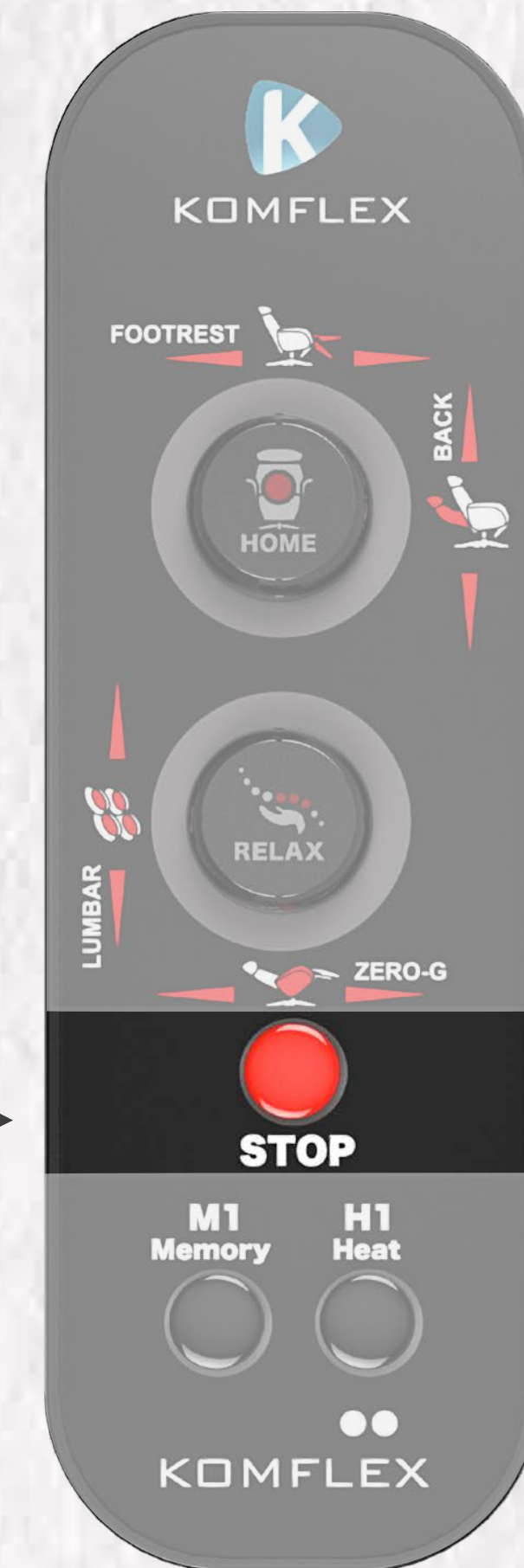

Stop Button

Red Button
“Side view”

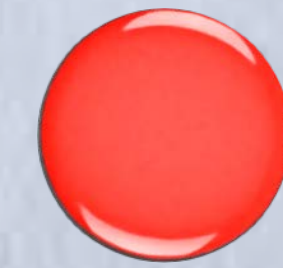

Stop
Button

Holding Down the
Stop Button for 3 Sec.

Power down the entire
system and return it to
the home position



Press
Down

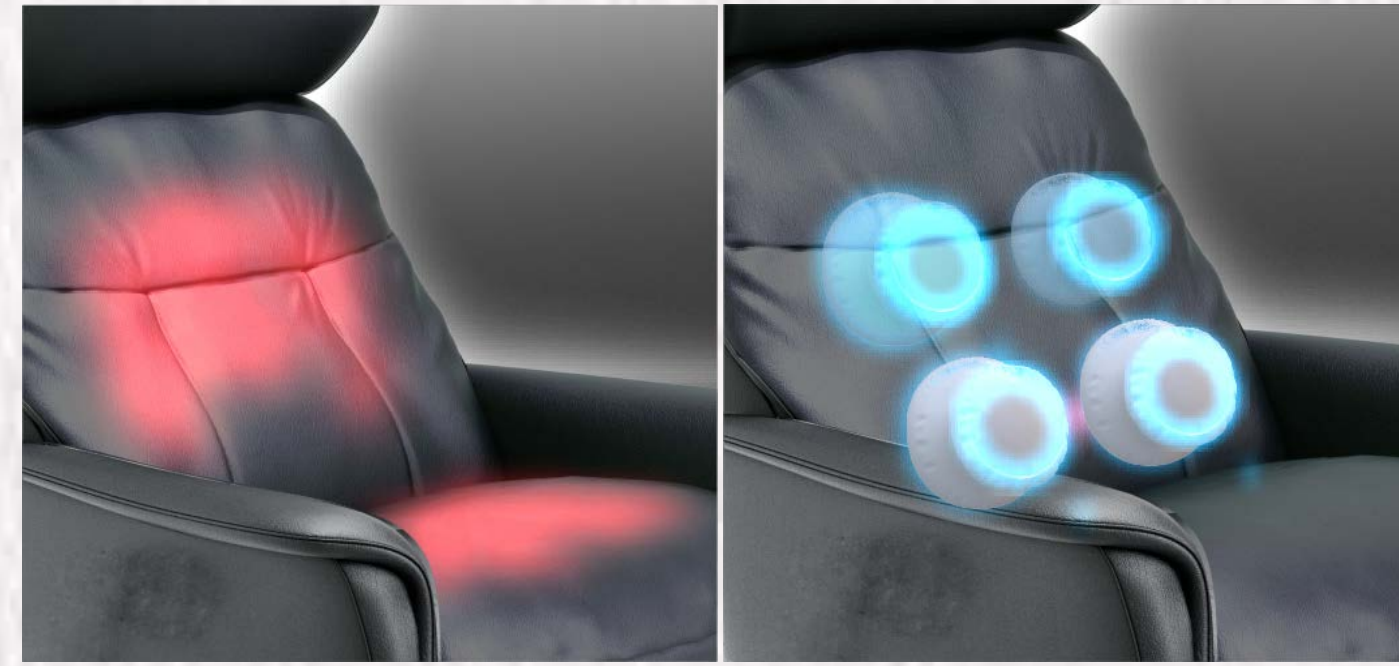

Heating System
Turn Off



Relax Mode
Turn Off



The Chair will return to
Home Position

User Manual for Hand Controller



By pressing the Memory button, the chair will seamlessly transition to the factory default zero gravity sitting position. However, if you desire a personalized angle, simply hold down the button for 3 seconds to initiate a reset and configure a new position tailored to your individual preferences.

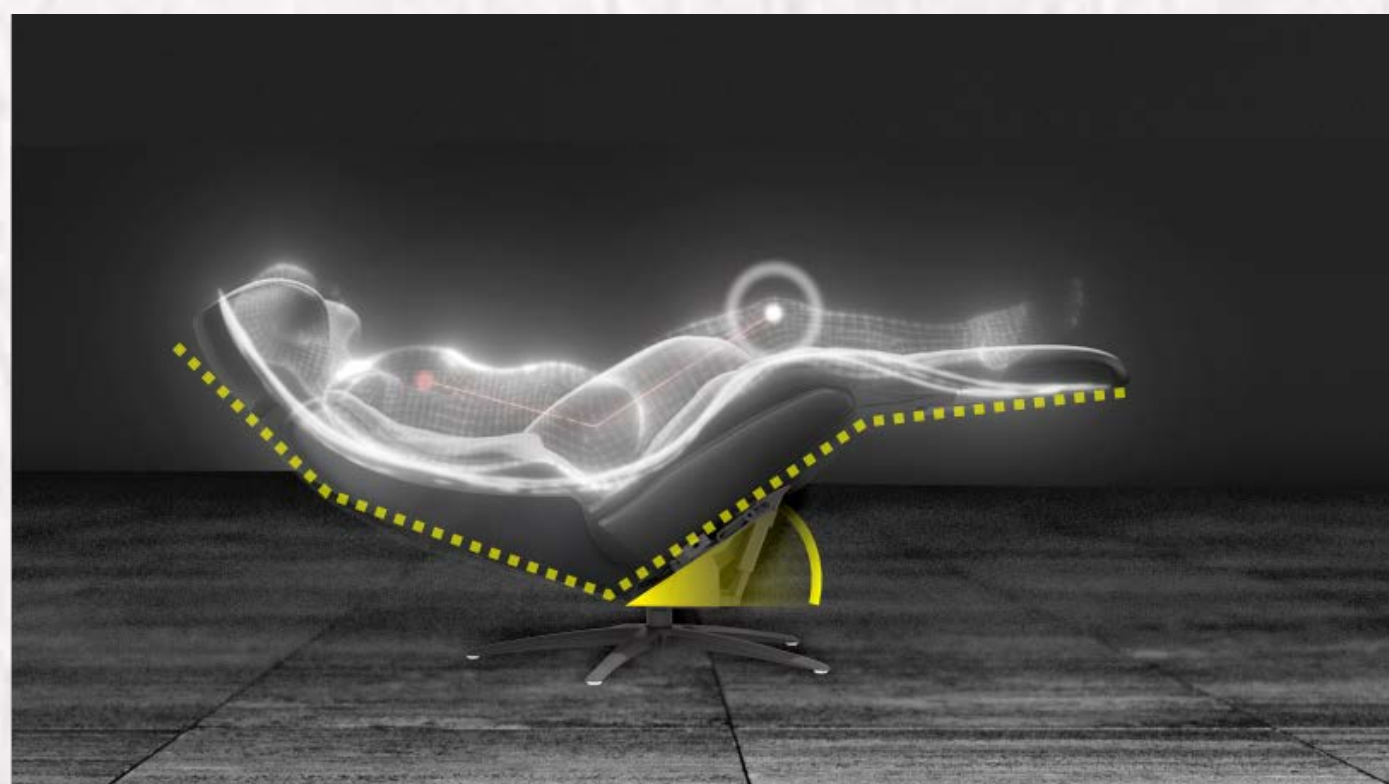

Memory
Mode

M1
Memory



Press
Down



Left Black Button
"Side view"

Reset Position

M1
Memory

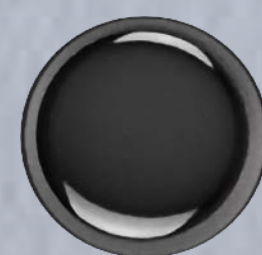

Press & Hold
Down 3Sec.

Set your desired chair sitting position, simply press and hold the button for 3 seconds until you hear a signal sound, indicating that the new angle has been recorded.

"Top view"



Memory
Button

Heater
Button

L A Z B O Y

KOMFLEX

AIR COLLECTION

User Manual for Hand Controller



Press the button once, and the two LED lights below will illuminate, indicating that the heating function is activated. Within 30 seconds, you will begin to feel a gradual increase in

The heating system will automatically turn off after 30 minutes, but you can press the button again if you wish to

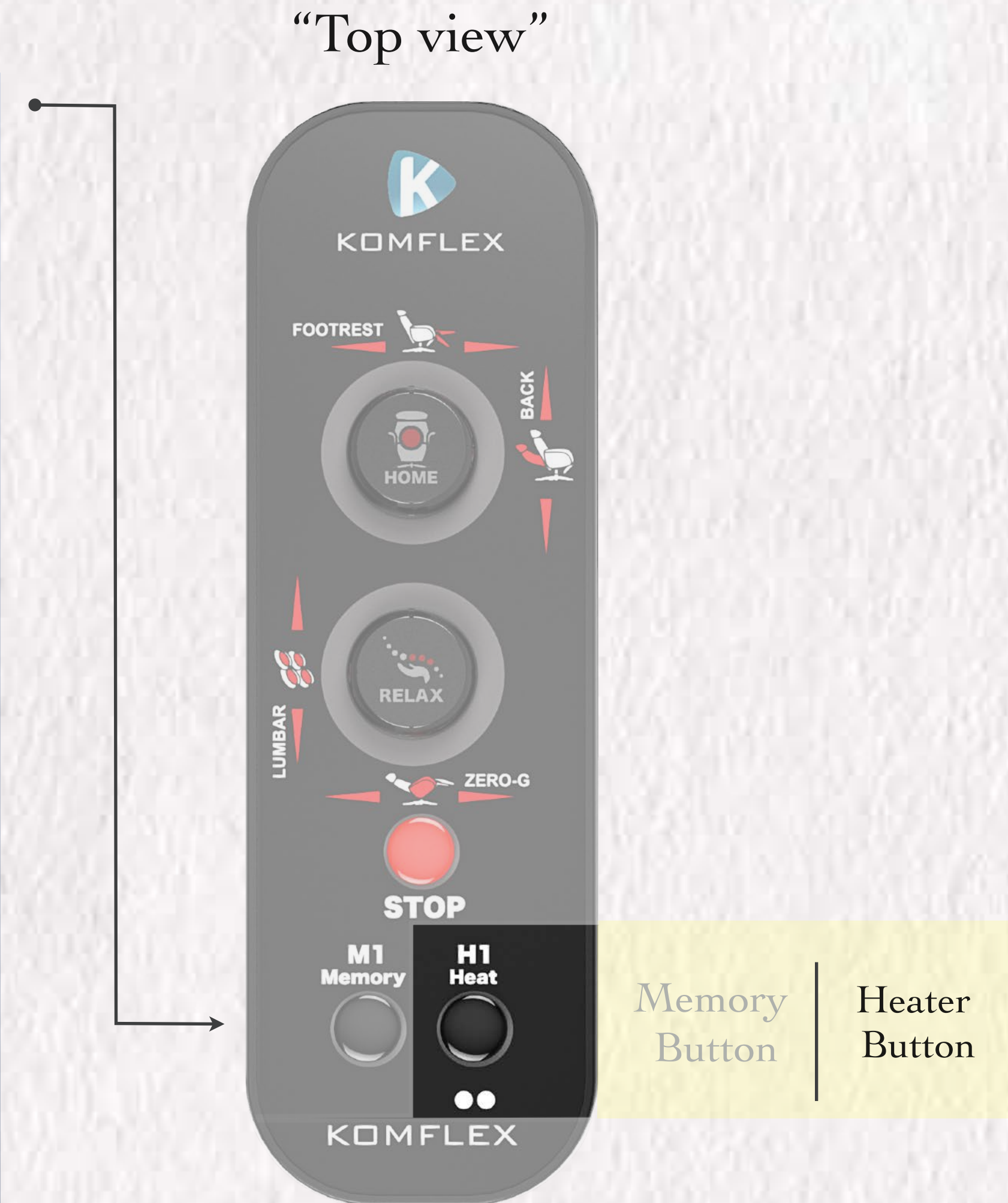
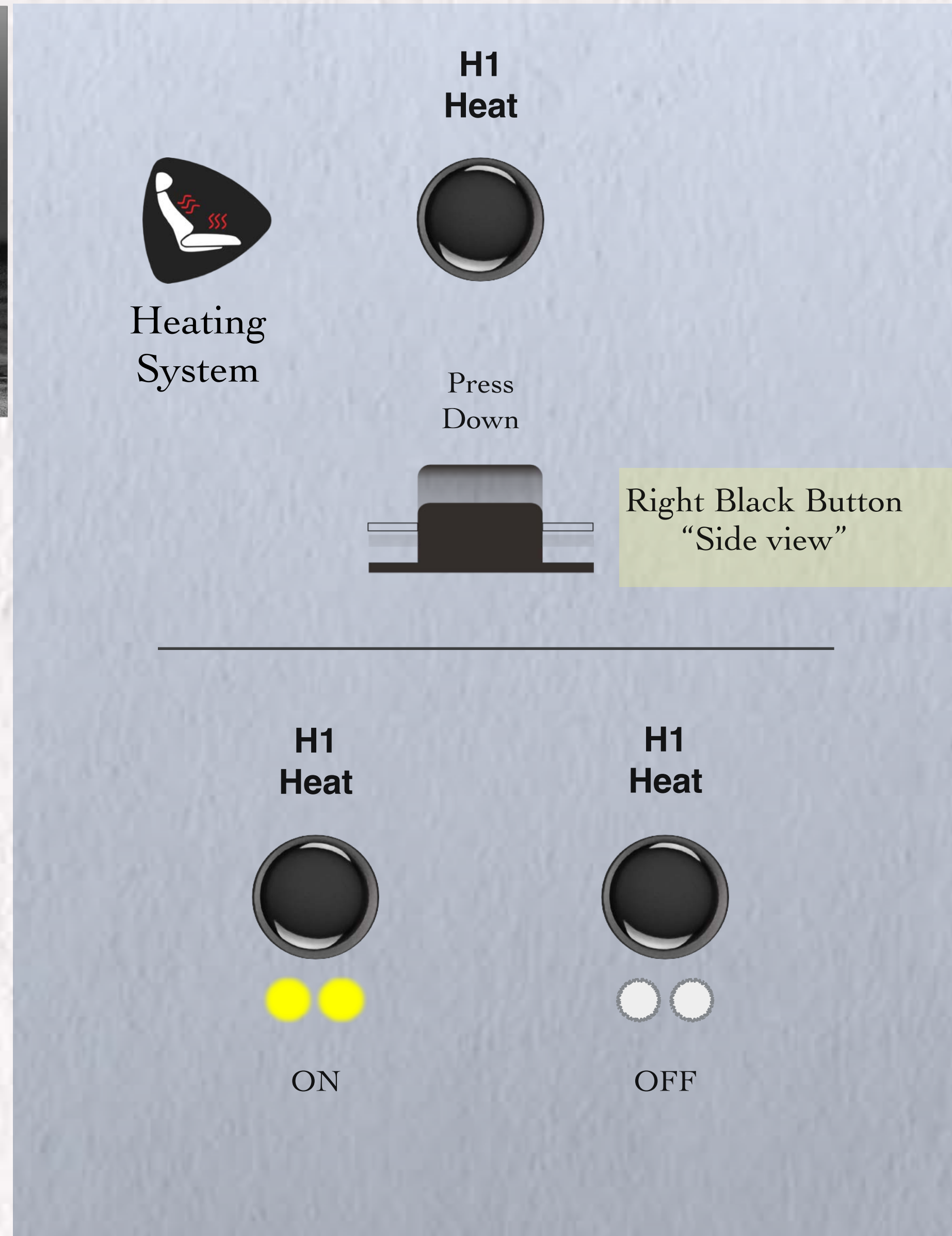

Safety Guideline

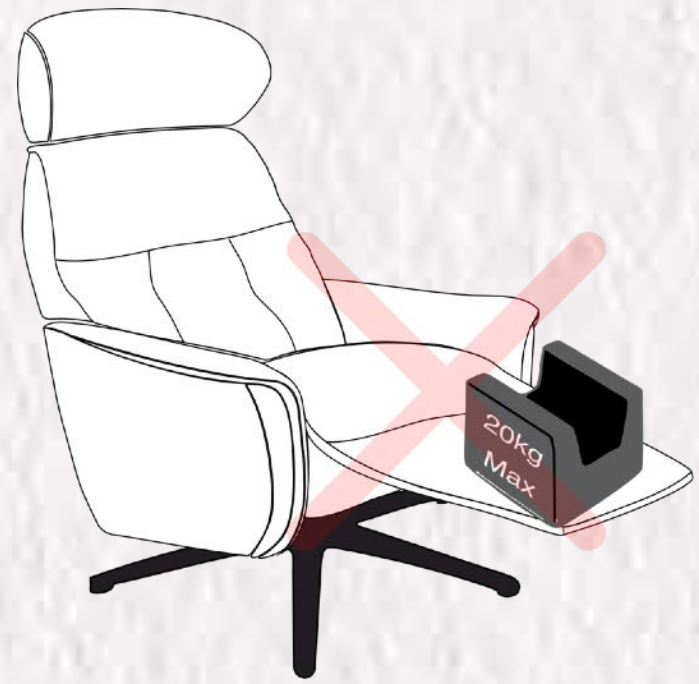

It is crucial to refrain from placing any objects weighing more than 20 kilograms on the footrest, as this exceeds the recommended weight limit and may compromise the structural integrity of the chair.



For enhanced safety, it is imperative to prevent children & Adult from standing or climbing on chairs.

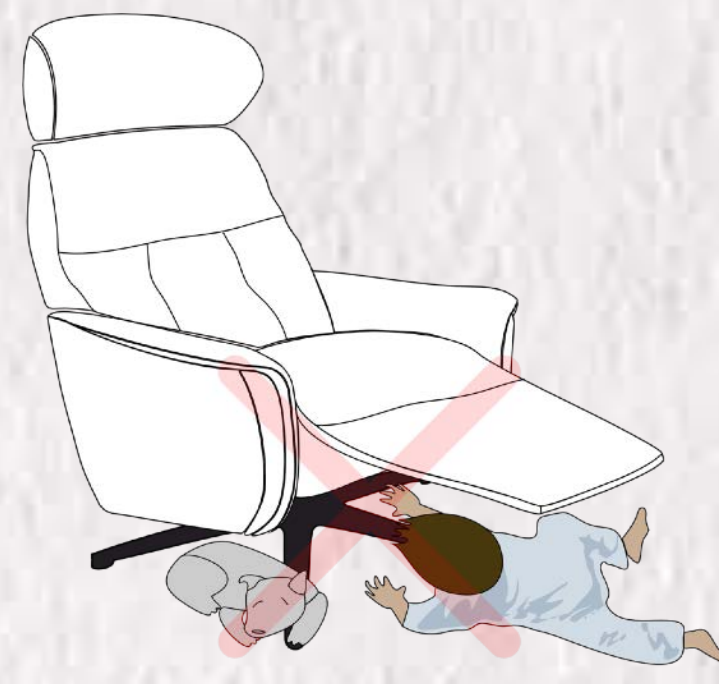

It is imperative to avoid lingering underneath chairs for recreational or hiding purposes.

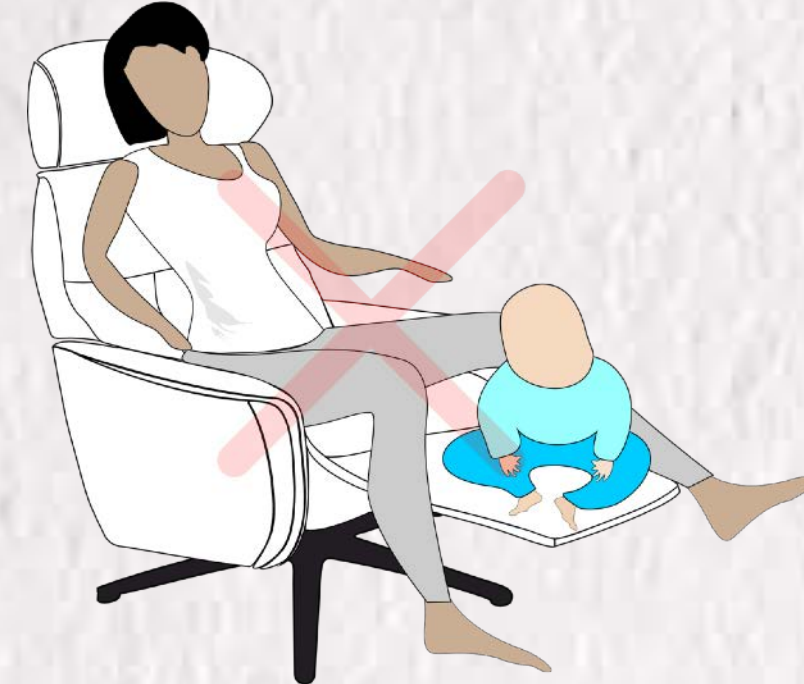

The chair is designed for a maximum of one person only. It is essential to comply with this occupancy limit for stability and safety reasons. Avoid sitting on the footrest area as it is not intended to support weight and may compromise the chair's structure. Please adhere to these guidelines to ensure optimal functionality and user safety.



To maintain a safe environment, it is essential to adhere to proper usage guidelines for the chair. Please refrain from sitting on the armrests as they are not designed to support body weight and may lead to safety concerns. Additionally, it is crucial to utilize the chair with correct posture to prevent any potential discomfort or accidents.



To ensure optimal safety and stability, it is important to refrain from engaging in any rocking or tilting motions while seated on the chair.

L A Z B O Y

KOMFLEX

AIR COLLECTION

Other Hidden Features

Duration Control and Activation of Massage and Heating Systems in Chairs

The massage and heating functions have a built-in auto-shutoff that engages after 30 minutes of continuous operation as a safety precaution. To resume use after auto-shutoff, the user can manually restart these features via the remote control. For users who wish to adjust the auto-shutoff duration, a 3-position selector switch is located on the underside of the control box. The leftmost position sets the auto-shutoff time to 30 minutes, the middle position to 45 minutes, and the rightmost position to 60 minutes. The system is preset from the factory to the 30 minute auto-shutoff default for safety purposes.

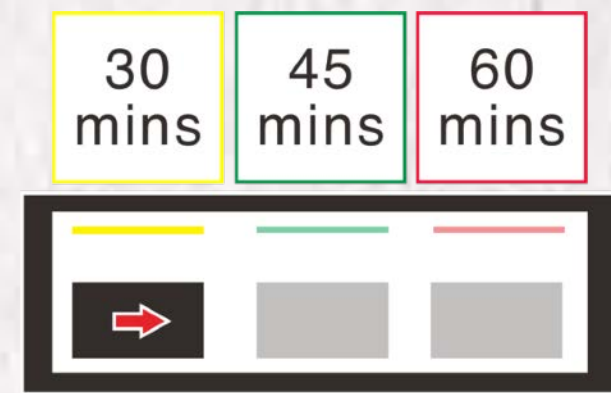

Safety Features for Reclining and Zero Gravity Functions in Chairs

In order to ensure safety, the chair's computer system employs distinct extension angles for the reclining function and the zero gravity function. The reclining function permits a greater range of motion. When transitioning from the reclined position to the zero gravity sitting position, the system conducts an assessment to determine if the current recline angle exceeds the safety standards established for the zero gravity mode. If the system identifies that the recline angle surpasses the prescribed safety threshold, it automatically readjusts the backrest angle to align with the designated safe position. Subsequently, it proceeds to activate the zero gravity mode, enabling the user to assume the desired sitting position with optimal safety.

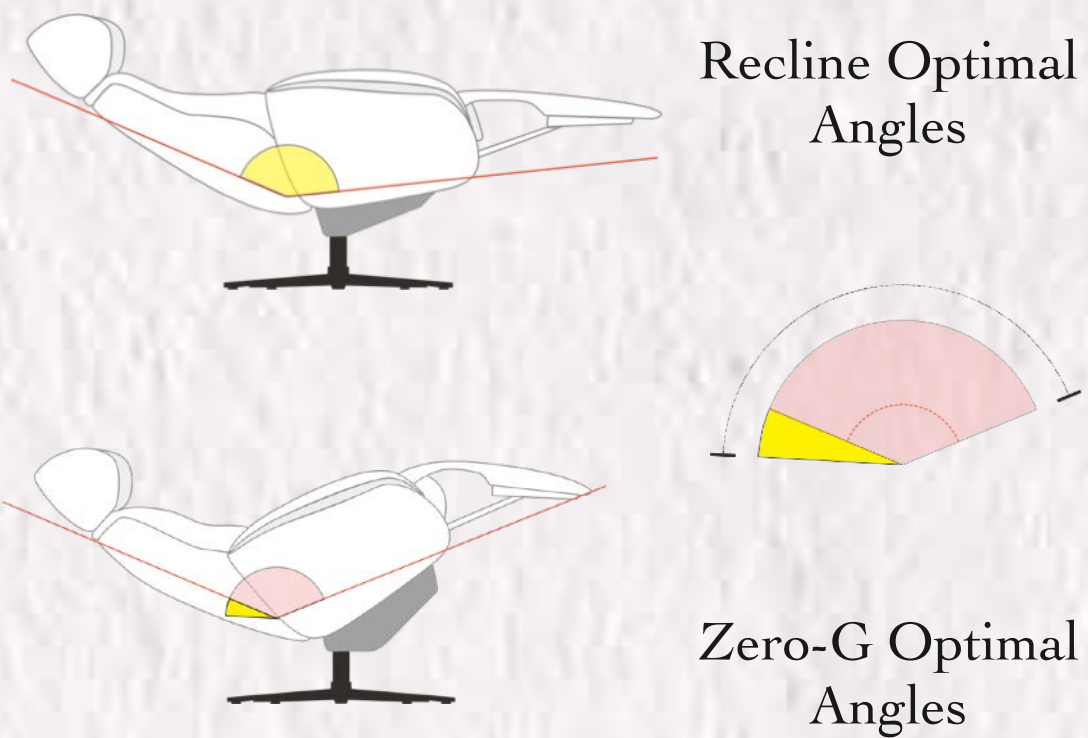

Factory Default Settings.

The chair's computer system comes preconfigured with Memory System M1 set as the standard for zero gravity position. However, users have the flexibility to modify the settings of Memory System M1 as desired. To restore the chair to its original factory settings, an option is available by pressing and holding both the M1 and H1 buttons simultaneously for 10 seconds. Upon hearing a signal sound, the chair's configuration will be reset to the factory default settings.

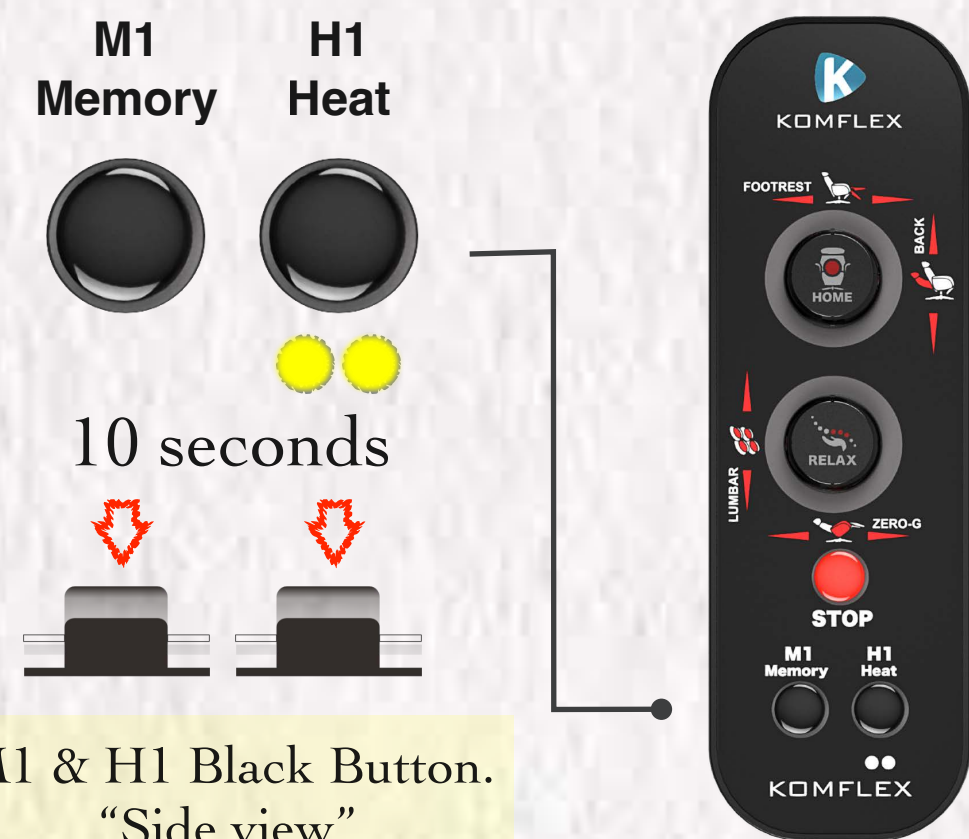

M1 & H1 Black Button. "Side view"

